

Courtesy Of Rohin Geis and Victor Moroz Of Royal LePage Noralta Real Estate

\$524,999 - 7 52111 Range Rd 270, Rural Parkland County

MLS® #E4407989

\$524,999

0 Bedroom, 0.00 Bathroom,
Land Commercial on 0.00 Acres

Sandhills Estates, Rural Parkland County, AB

Prime Development Opportunity in Edmonton Parkland Executive Airport! Seize the chance to own a 0.6-acre lot in the Edmonton Parkland Executive Airport, located in between two lots, offering access to the runway. With paved taxiways, natural gas and power to the lots, this parcel provides an ideal foundation for various hangar or shop configurations to meet your specific needs. Each lot will require an independent septic and cistern system Zoned AGG, this versatile lot offers flexibility for aviation-related or other commercial developments.



Essential Information

MLS® #	E4407989
Price	\$524,999
Bathrooms	0.00
Acres	0.00
Type	Land Commercial
Status	Active

Community Information

Address	7 52111 Range Rd 270
Area	Rural Parkland County
Subdivision	Sandhills Estates
City	Rural Parkland County

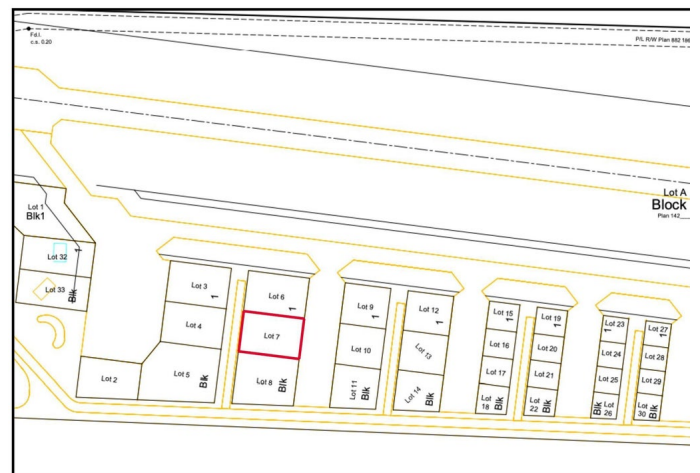

County ALBERTA
Province AB
Postal Code T7X 3M2

Additional Information

Date Listed September 26th, 2024
Days on Market 202
Zoning Zone 90

DATA IS DEEMED RELIABLE BUT IS NOT GUARANTEED ACCURATE BY THE REALTORS® ASSOCIATION OF EDMONTON. COPYRIGHT 2025 BY THE REALTORS® ASSOCIATION OF EDMONTON. ALL RIGHTS RESERVED. Trademarks are owned or controlled by the Canadian Real Estate Association (CREA) and identify real estate professionals who are members of CREA (REALTOR®, REALTORS®) and/or the quality of services they provide (MLS®, Multiple Listing Service®)

Listing information last updated on April 16th, 2025 at 1:02pm MDT